

Descriptions

The CT0230ZP is schottky barrier diode, DFN1006-2L plastic package.

Features

- Small Surface Mounting Type
- Ideal for Automated Placement
- Ultrafast Reverse Recovery Time
- Low Power Losses, High Efficiency
- Low Forward Voltage Drop
- RoHS Compliant

Applications

- High speed switch for detection
- For portable equipment:(Mobile phone, MP3, MD,CD-ROM, DVD-ROM, Note book PC, etc.)

Mechanical Characteristics

- Lead Finish:Matte Tin
- Case Material: "Green" Molding Compound
- UL Flammability Classification Rating 94V-0
- Moisture Sensitivity: Level 3 per J-STD-020
- Tape Reel :10000pcs

Equivalent Circuit & Pinning

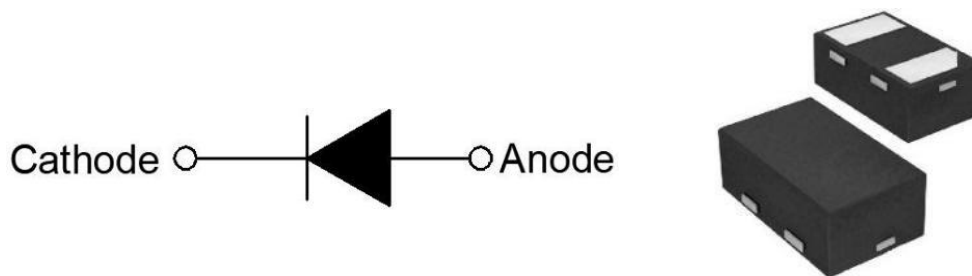

Absolute Maximum Ratings(Ta=25°C)

Parameters	Symbol	Limit	Unit
Reverse Voltage (Repetitive Peak)	VRRM	30	V
DC Blocking Voltage	VR	30	V
RMS reverse Voltage	VR(RMS)	24	V
Average Rectified Output Current	IO	0.2	A
Non-repetitive Peak Forward Surge Current@t=8.3ms	IFSM	0.5	A
Power Dissipation	PD	100	mW
Thermal Resistance Junction to Ambient(Typ)	RθJA	120	°C/W
Junction Temperature	TJ	-55 ~ +125	°C
Storage Temperature	TSTG	-55 ~ +150	°C

Electrical Characteristics(Ta=25°C)

Parameters	Symbol	Test conditions	Min.	Typ	Max.	Unit
Breakdown Voltage	VBR	IR=100uA	30			V
Reverse Current	IR	VR=10V			1	uA
Forward Voltage	VF	IF=10mA			0.45	V
		IF=200mA			0.6	
Total Capacitance	CT	VR=0V,f=1MHz		20		pF

Typical Characteristics

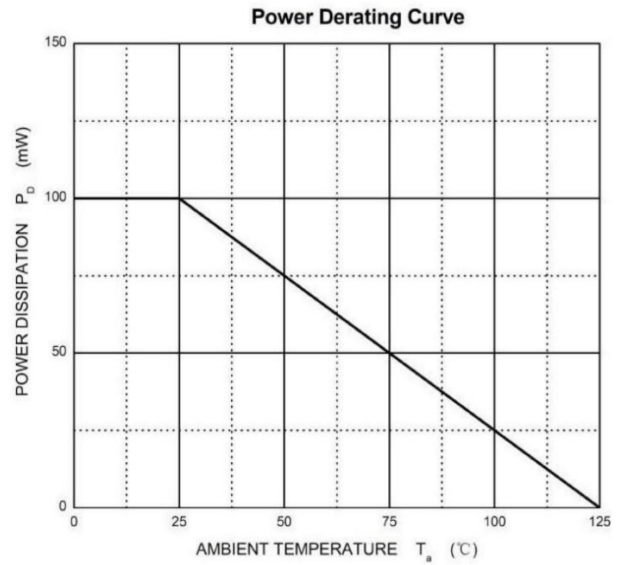
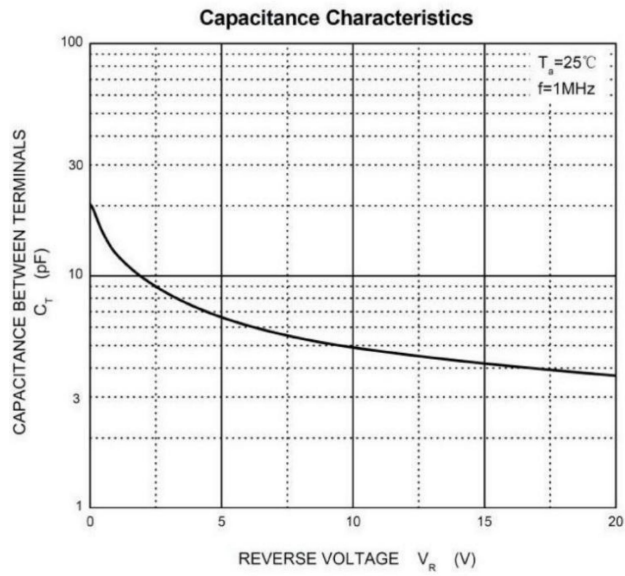
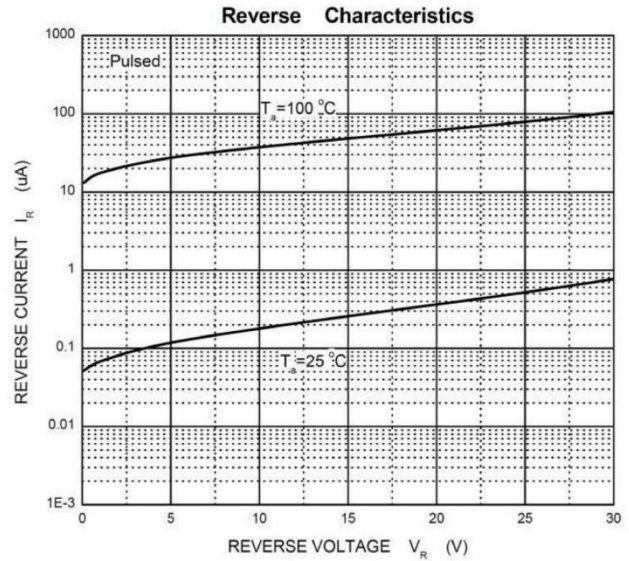
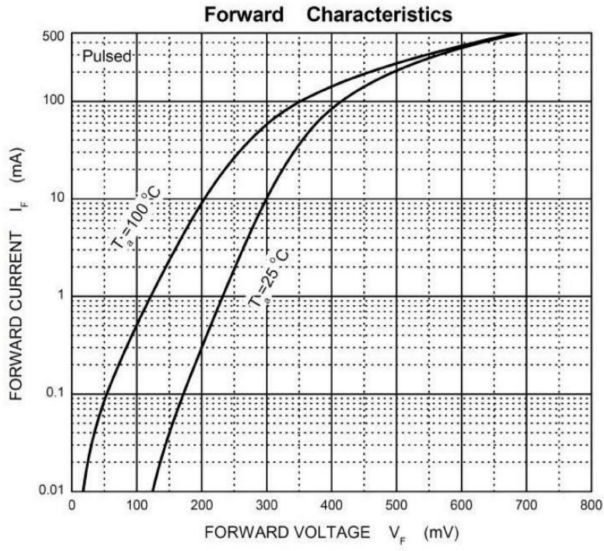

Marking Information

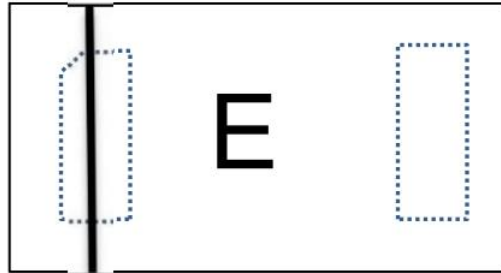

E=Marking Code

Package mechanical data

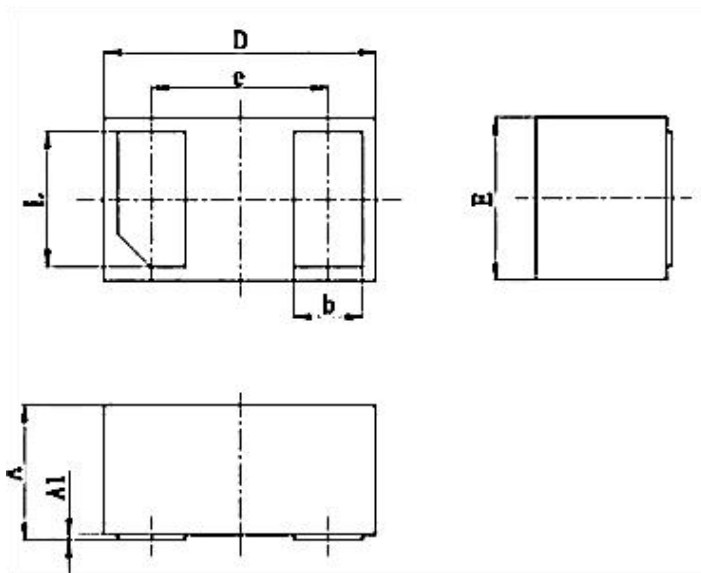

Symbol	Dimension in Millimeters	
	min	max
A	0.4	0.5
A1	0	0.05
D	0.9	1.1
E	0.55	0.65
e	(0.65)	
b	0.2	0.3
L	0.34	0.55

Tape & reel specification - DFN1006

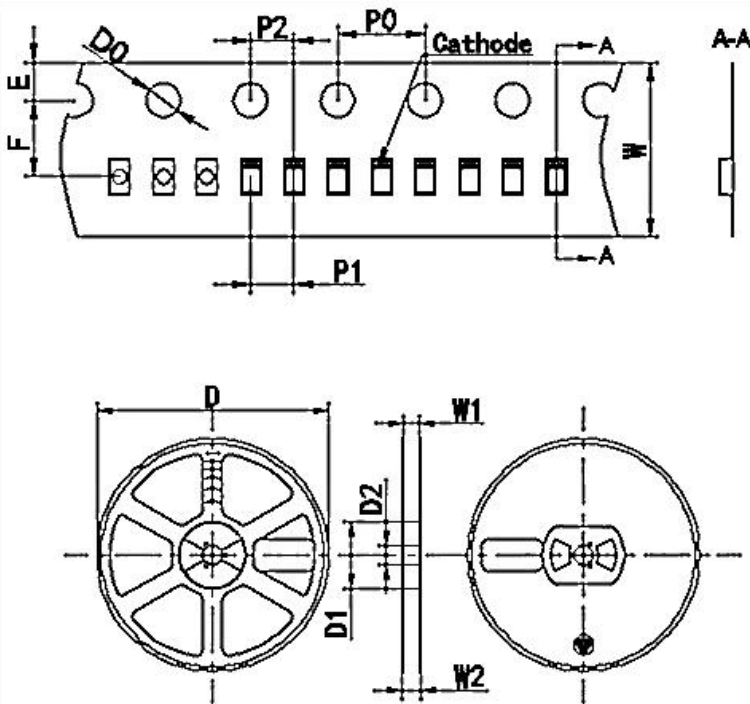

Symbol	Dimension in Millimeters
Tape	
D0	1.50+0.10/-0.00
E	1.75±0.10
F	3.50±0.10
P0	4.00±0.10
P1	2.00±0.10
P2	2.00±0.10
W	8.00+0.3/-0.1
Reel	
D	178.0±2.00
D1	54.40±1.00
D2	13.00±1.00
W1	9.50±1.00
W2	12.30±1.00